

Application to vary a premises licence under the Licensing Act 2003

**PLEASE READ THE FOLLOWING INSTRUCTIONS FIRST**

Before completing this form please read the guidance notes at the end of the form. If you are completing this form by hand please write legibly in block capitals. In all cases ensure that your answers are inside the boxes and written in black ink. Use additional sheets if necessary.

You may wish to keep a copy of the completed form for your records.

I/We SADEQ AHMED MANNAN  
(Insert name(s) of applicant)

being the premises licence holder, apply to vary a premises licence under section 34 of the Licensing Act 2003 for the premises described in Part 1 below

Premises licence number	713.
-------------------------	------

**Part 1 – Premises Details**

Postal address of premises or, if none, ordnance survey map reference or description			
INDIA COTTAGE, RESTAURANT. 35 CHRIST CHURCH RD			
MAP REF (E) 414936.500 824781.		UPRN-100062213705.	
" " (N) 105131.410 648 978			
Post town	RINGWOOD	Postcode	BH24 1DG

Telephone number at premises (if any)	01425 473671.
Non-domestic rateable value of premises	£ 7800.00.

**Part 2 – Applicant details**

Daytime contact telephone number	[REDACTED]		
E-mail address (optional)	[REDACTED]		
Current postal address if different from premises address	17 TALBOT HILL RD BOURNEMOUTH		
Post town	BIMMIA	Postcode	BH9 2JT

Chq: 005010

Kitlu Ltd

**Part 3 - Variation**

Please tick as appropriate

Do you want the proposed variation to have effect as soon as possible?

Yes

No

If not, from what date do you want the variation to take effect?

DD	MM	YYYY

Please describe briefly the nature of the proposed variation (Please see guidance note 1)

SEE ATTACHED

If your proposed variation would mean that 5,000 or more people are expected to attend the premises at any one time, please state the number expected to attend:

--

#### Part 4 Operating Schedule

Please complete those parts of the Operating Schedule below which would be subject to change if this application to vary is successful.

##### Provision of regulated entertainment

Please tick all that apply

- a) plays (if ticking yes, fill in box A)
- b) films (if ticking yes, fill in box B)
- c) indoor sporting events (if ticking yes, fill in box C)
- d) boxing or wrestling entertainment (if ticking yes, fill in box D)
- e) live music (if ticking yes, fill in box E)
- f) recorded music (if ticking yes, fill in box F)
- g) performances of dance (if ticking yes, fill in box G)
- h) anything of a similar description to that falling within (e), (f) or (g) (if ticking yes, fill in box H)

Provision of late night refreshment (if ticking yes, fill in box I)

Sale by retail of alcohol (if ticking yes, fill in box J)

In all cases complete boxes K, L and M

E

Live music Standard days and timings (please read guidance note 6)			Will the performance of live music take place indoors or outdoors or both -- please tick (please read guidance note 2)		Indoors	<input type="checkbox"/>
					Outdoors	<input type="checkbox"/>
					Both	<input checked="" type="checkbox"/>
Day	Start	Finish	Please give further details here (please read guidance note 3)			
Mon			WE ARE A SMALL RESTAURANT AND ONLY INTEND ON HAVING SOME PIANO OR SOMEONE TO SING, GENERALLY UN-AMPLIFIED TO CREATE AN AMBIENCE IN THE RESTAURANT.			
Tue						
Wed			State any seasonal variations for the performance of live music (please read guidance note 4)			
Thur			Non standard timings. Where you intend to use the premises for the performance of live music at different times to those listed in the column on the left, please list (please read guidance note 5)			
	18:00	00:00				
Fri						
	18:00	00:00				
Sat						
	18:00	00:00				
Sun						

Recorded on existing licence for indoors only  
 Music - now for both.

F

Recorded music Standard days and timings (please read guidance note 6)			Will the playing of recorded music take place Indoors or outdoors or both - please tick (please read guidance note 2)	Indoors	<input type="checkbox"/>
				Outdoors	<input type="checkbox"/>
				Both	<input checked="" type="checkbox"/>
Day	Start	Finish			
Mon	12.00	14.30	Please give further details here (please read guidance note 3) WE A RESTAURANT AND ONLY PLAY BACKGROUND RECORDED MUSIC		
	18.00	00.00			
Tue	12.00	14.30			
	18.00	00.00			
Wed	12.00	14.30	State any seasonal variations for the playing of recorded music (please read guidance note 4)		
	18.00	00.00			
Thur	12.00	14.30			
	18.00	00.00			
Fri	12.00	14.30	Non standard timings. Where you intend to use the premises for the playing of recorded music at different times to those listed in the column on the left, please list (please read guidance note 5)		
	18.00	00.00			
Sat	12.00	14.30			
	18.00	00.00			
Sun	12.00	14.30			
	18.00	00.00			

Late night refreshment Standard days and timings (please read guidance note 6)			Will the provision of late night refreshment take place indoors or outdoors or both – please tick (please read guidance note 2)	Indoors	<input type="checkbox"/>
Day	Start	Finish		Outdoors	<input type="checkbox"/>
Mon	<del>12.00</del> 23.00	<del>14.30</del> 00.00	Please give further details here (please read guidance note 3) AS A RESTAURANT WE ONLY SUPPLY ALCOHOL TO GUEST EATING DINNER, THIS MINOR VARIATION IS TO ALLOW GUEST TO DRINK AND EAT OUR GARDEN AREA ATTACHED TO THE BUILDING	Both	<input checked="" type="checkbox"/>
Tue	<del>12.00</del> 23.00	<del>14.30</del> 00.00		State any seasonal variations for the provision of late night refreshment (please read guidance note 4)	
Wed	<del>12.00</del> 23.00	<del>14.30</del> 00.00	WEATHER PERMITTING		
Thur	<del>12.00</del> 23.00	<del>14.30</del> 00.00			
Fri	<del>12.00</del> 23.00	<del>14.30</del> 00.00	Non standard timings. Where you intend to use the premises for the provision of late night refreshment at different times, to those listed in the column on the left, please list (please read guidance note 5)		
Sat	<del>12.00</del> 23.00	<del>14.30</del> 00.00			
Sun	<del>12.00</del> 23.00	<del>14.30</del> 00.00			

J

Supply of alcohol Standard days and timings (please read guidance note 6)			Will the supply of alcohol be for consumption - please tick (please read guidance note 7)	On the premises	<input checked="" type="checkbox"/>			
				Off the premises	<input type="checkbox"/>			
				Both	<input type="checkbox"/>			
Day	Start	Finish						
Mon	12.00	14.30	<u>State any seasonal variations for the supply of alcohol</u> (please read guidance note 4) THE RESTAURANT IS OPEN A LUNCH BETWEEN 12.00 - 14.30 AND 18.00 - 00.00 WHERE GUESTS CAN DRINK WITH DINNER.					
		18.00				00.00		
Tue	12.00	14.30						
		18.00				00.00		
Wed	12.00	14.30						
		18.00				00.00		
Thur	12.00	14.30				<u>Non-standard timings. Where you intend to use the premises for the supply of alcohol at different times to those listed in the column on the left, please list</u> (please read guidance note 5)		
		18.00						
Fri	12.00	14.30						
		18.00						
Sat	12.00	14.30						
		18.00	00.00					
Sun	12.00	14.30						
		18.00	00.00					

K

Please highlight any adult entertainment or services, activities, other entertainment or matters ancillary to the use of the premises that may give rise to concern in respect of children (please read guidance note 8).

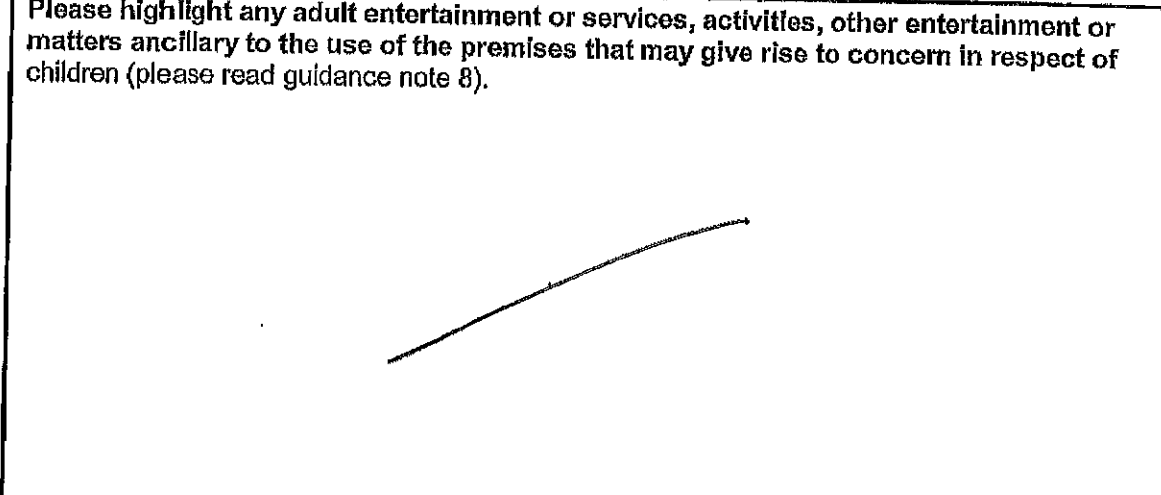

L

<b>Hours premises are open to the public</b> Standard days and timings (please read guidance note 6)			<b>State any seasonal variations</b> (please read guidance note 4)
Day	Start	Finish	
Mon	12:00	14:30	
	18:00	00:00	
Tue	12:00	14:30	
	18:00	00:00	
Wed	12:00	14:30	
	18:00	00:00	
Thur	12:00	14:30	
	18:00	00:00	
Fri	12:00	14:30	
	18:00	00:00	
Sat	12:00	14:30	
	18:00	00:00	
Sun	12:00	14:30	
	18:00	00:00	
<b>Non standard timings. Where you intend the premises to be open to the public at different times from those listed in the column on the left, please list</b> (please read guidance note 5)			

Please identify those conditions currently imposed on the licence which you believe could be removed as a consequence of the proposed variation you are seeking.



Please tick as appropriate

- I have enclosed the premises licence
- I have enclosed the relevant part of the premises licence



If you have not ticked one of these boxes, please fill in reasons for not including the licence or part of it below

Reasons why I have not enclosed the premises licence or relevant part of premises licence.

**M**

Describe any additional steps you intend to take to promote the four licensing objectives as a result of the proposed variation:

**a) General – all four licensing objectives (b, c, d and e) (please read guidance note 9)**

**b) The prevention of crime and disorder**

SEE ATTACHED.

**c) Public safety**

SEE ATTACHED.

**d) The prevention of public nuisance**

**e) The protection of children from harm**

(M)

## General

The premises has been a restaurant in the town now for 39 years under the same ownership, and operates a strict policy to promote the four licensing objectives.

## Crime and disorder licensing objective

I Sadeq Mannan have DPS role, and in my absence I have a nominated responsible person to manage the premises. There is CCTV in operation and is continuously recording all licensing areas. The premises is a restaurant and guests are served with drinks during their meal, we have not had any incidents with physical altercation or disorder, physical ejection or injury. We have never had any incidents with drug misuse. We have an incident book at the premises but have never needed to use. Staff have been trained to identify and refuse anyone under 18, for the consumption of alcohol, along with the challenge 25 policy.

## Public Safety Licensing Objectives

With the help of Hampshire Fire, we have all fire precautions in place, this can be found in our Fire Risk Assessment which is reviewed once a year. The alarms and extinguishers along with staff training are all in place. This can be found in the Log Book. We have sufficient lighting inside and outside, with notices to guests in how they leave the premises.

## Prevention Of Public Nuisance Licensing Objective

The sale of alcohol is only permitted during meals and only in the designated area. As we have our own car park around this area, there is no chance of an over spill to a public area, nevertheless this is does not happen and is not permitted. All drinks are served in glasses and collected from the tables as necessary. We have a strict smoking policy, and only allowed in the smoking area where ash trays are located and regularly cleaned. All areas are still located in our own car park so there is no chance of litter in the public area. We do not promote any 'Happy Hour' drinking offers.

## Protection Of children From Harm Licensing Objective

We are a restaurant and will only permit children accompanied by an adult for dinner. No person under 18 will be permitted the sale of alcohol. We do not permit any nudity or any sexually stimulating performances. We operate the '25 Challenge Policy'.

Checklist:

Please tick to indicate agreement

- I have made or enclosed payment of the fee.
- I have sent copies of this application and the plan to responsible authorities and others where applicable.
- I understand that I must now advertise my application.
- I have enclosed the premises licence or relevant part of it or explanation.
- I understand that if I do not comply with the above requirements my application will be rejected.

**IT IS AN OFFENCE, LIABLE ON SUMMARY CONVICTION TO A FINE NOT EXCEEDING LEVEL 5 ON THE STANDARD SCALE, UNDER SECTION 158 OF THE LICENSING ACT 2003, TO MAKE A FALSE STATEMENT IN OR IN CONNECTION WITH THIS APPLICATION.**

**Part 5 – Signatures** (please read guidance note 10)

**Signature of applicant (the current premises licence holder) or applicant's solicitor or other duly authorised agent (please read guidance note 11). If signing on behalf of the applicant, please state in what capacity.**

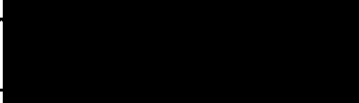
Signature	
Date	8/12/18.
Capacity	

**Where the premises licence is jointly held, signature of 2nd applicant (the current premises licence holder) or 2nd applicant's solicitor or other authorised agent (please read guidance note 12). If signing on behalf of the applicant, please state in what capacity.**

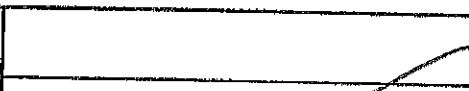
Signature	
Date	
Capacity	

**Contact name (where not previously given) and address for correspondence associated with this application (please read guidance note 13)**

Post town		Post code	
Telephone number (if any)			
If you would prefer us to correspond with you by e-mail, your e-mail address (optional)			

## Notes for Guidance

**This application cannot be used to vary the licence so as to extend the period for which the licence has effect or to vary substantially the premises to which it relates. If you wish to make that type of change to the premises licence, you should make a new premises licence application under section 17 of the Licensing Act 2003.**

1. Describe the premises. For example the type of premises, its general situation and layout and any other information which could be relevant to the licensing objectives. Where your application includes off-supplies of alcohol and you intend to provide a place for consumption of these off-supplies, you must include a description of where the place will be and its proximity to the premises.
2. Where taking place in a building or other structure please tick as appropriate (indoors may include a tent).
3. For example state type of activity to be authorised, if not already stated, and give relevant further details, for example (but not exclusively) whether or not music will be amplified or unamplified.
4. For example (but not exclusively), where the activity will occur on additional days during the summer months.
5. For example (but not exclusively), where you wish the activity to go on longer on a particular day e.g. Christmas Eve.
6. Please give timings in 24 hour clock (e.g. 16:00) and only give details for the days of the week when you intend the premises to be used for the activity.
7. If you wish people to be able to consume alcohol on the premises, please tick 'on the premises'. If you wish people to be able to purchase alcohol to consume away from the premises, please tick 'off the premises'. If you wish people to be able to do both, please tick 'both'.
8. Please give information about anything intended to occur at the premises or ancillary to the use of the premises which may give rise to concern in respect of children regardless of whether you intend children to have access to the premises, for example (but not exclusively) nudity or semi-nudity, films for restricted age groups or the presence of gaming machines.
9. Please list here steps you will take to promote all four licensing objectives together.
10. The application form must be signed.
11. An applicant's agent (for example solicitor) may sign the form on their behalf provided that they have actual authority to do so.
12. Where there is more than one applicant, each of the applicants or their respective agents must sign the application form.
13. This is the address which we shall use to correspond with you about this application.

**Premises Licence**

**variation**

**December 2019**

India Cottage Restaurant,  
35 Christchurch Road,  
Ringwood BH24 1DG

1/100

**Ground Floor and  
Outdoor Area Plan**



Existing open sided, covered area now proposed along with two converted sheds (2.1M x 1.5M) for outdoor eating and consumption of alcohol.

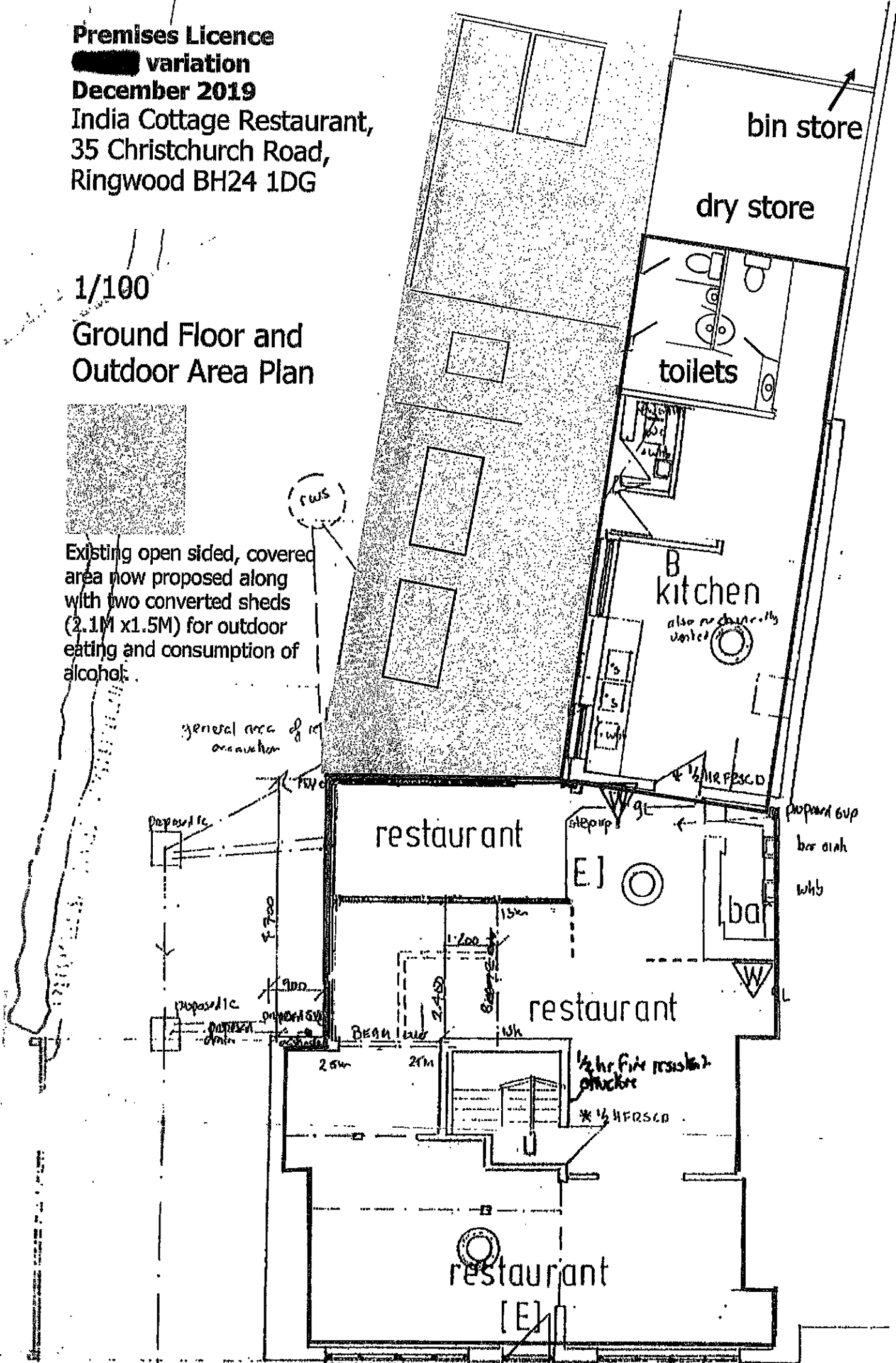

general area of occupation

restaurant

B kitchen

bin store

dry store

toilets

bar

restaurant

restaurant

[E]

7.00

1.50

2.50

2.10

1/2 hr fire resist. structure

\* 1/2 hr fire resist. structure

proposed

proposed

proposed

BEAN

E

W

W

outward cup  
bar dia  
whb

POST OFFICE  
CAR PARKING

RECENT  
MILKMAKERS  
BLOCK

Redevelopment  
access

Bin  
store

DRY  
store

GENS

LADIES

TOILETS

TOILET  
FOUR

STORAGE  
AREA

STAYS

STAYS  
(KITCHEN)

GARDEN AREA  
FOR DRINKING  
AND EATING.

TOILET  
FOUR

KITCHEN

pedestrian  
access

entrance

restaurant

bar

restaurant

restaurant

FRONT WINDOW

FRONT WINDOW

ENTRANCE FROM  
STREET INTO  
CAR PARK

THE RED  
HIGHLIGHTS  
THE  
BOUNDARY  
TO OUR  
NEIGHBOUR

1/100  
SCALE

